

# Add a Mediasite Channel in Brightspace

Mediasite in Brightspace is available to add videos for your students. A Channel is a collection of videos. You can use the Upload/Create to use the Brightspace Editor with the Insert Stuff button. Use this method if you want to include additional content with the channel and/or if you want to embed the channel within Brightspace. If the video channel is embedded, students don't have to navigate back to the Brightspace tab in their browser.

You can use Existing Activities to add a channel link and the description that you added for the channel in Mediasite with no additional content. Students will need to navigate back to the Brightspace tab in their browser after accessing the channel.

## [Watch Video Tutorial](#)

### 1. How to add a Mediasite Channel in Brightspace using Upload/Create

**Step 1: In the course and module you desire, select Upload/Create.**

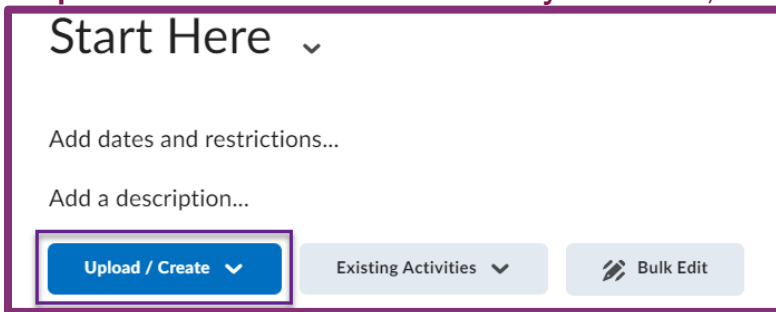

**Step 2: Select Create a File.**

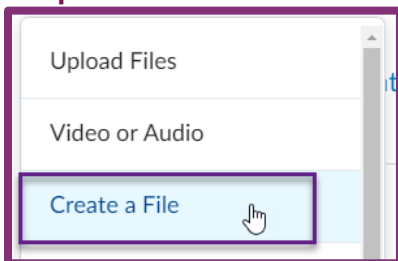

**Step 3: Enter a file title (1) and select the Insert Stuff button (2).**

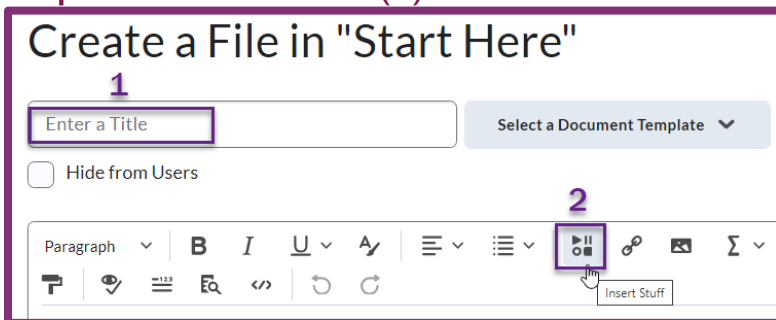

## Step 4: Select Mediasite Link.

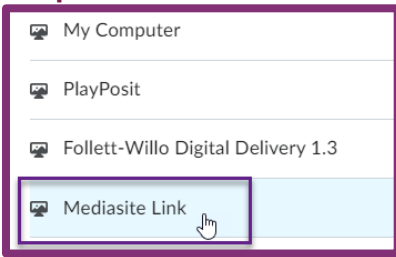

## Step 5: Filter for Channel in the search box

1. When the Mediasite search box opens, select the drop-down arrow to filter the results.
2. Check the box for Channel.
3. Select Apply

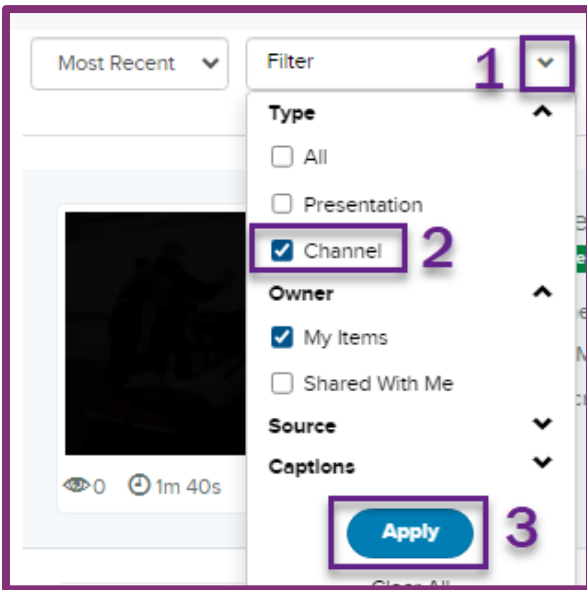

## Step 6: Select Link Video or Embed.

Linking the channel displays an external link with the channel description from Mediasite. When embedding the channel, students click to open a page within Brightspace where they can play the videos.



## Step 7: Select Insert.

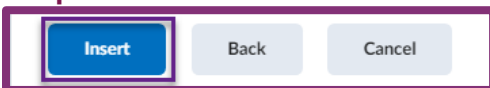

## Step 8: Complete the process.

Once you insert the Mediasite video into the Brightspace Editor, you can add any additional content you want to include. When you are finished, select Save and Close.



## 4. How to add a Mediasite Channel in Brightspace using Existing Activities

**Step 1:** In the course and module you desire, select Existing Activities.

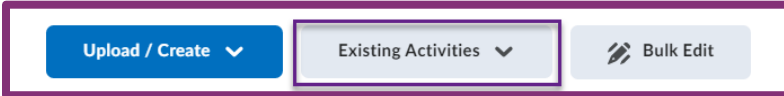

**Step 2:** Select Mediasite Link.

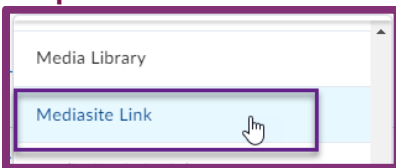

**Step 3:** Filter for Channel in the search box

5. When the Mediasite search box opens, select the drop-down arrow to filter the results.
6. Check the box for Channel.
7. Select Apply

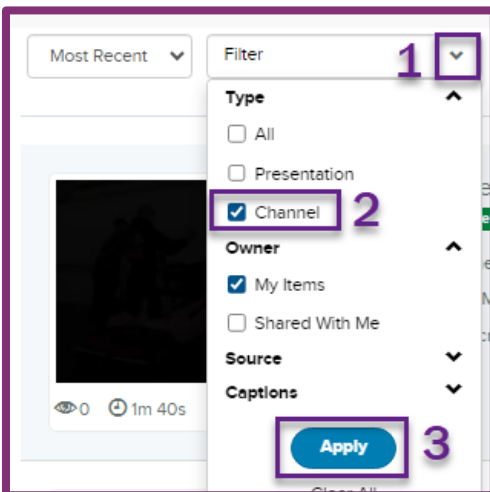

**Step 4:** Select Link to complete the process.

Linking the channel displays an external link with the channel description from Mediasite. The channel description will be displayed. When linking to the channel using the Existing Activities method, choosing Embed will create a link.

